

## SUBMITTAL SHEET

JOB NAME	ITEM TAG
JOB LOCATION	PART NUMBER
CONTRACTOR	DATE
ENGINEER APPROVAL	DATE

### LEAD-FREE PACK JOINT UNION

#### T-4301NL

Lead-free design is suitable for all no-lead potable water installations, in full compliance of all lead-free plumbing laws. CTS pack-joint end connections provide the maximum pullout resistance against internal pressure variations and backfilling stress.

**Designed and manufactured for the repair of, or new underground water service applications only.**

Insert stiffeners (Model T-4500, sold separately) are required at each pack-joint connection, when installing Polyethylene (PE) plastic tubing.

Available in nominal sizes 1/2" to 2" copper-tubing-size.

#### Working Pressure, Non Shock (PSI)

1/2"-1": 100 psi - 100°F Max  
1 1/4"-2": 80 psi - 100°F Max

- Third-party tested and certified in compliance with U.S. Federal Public Law 111-380 (National lead-free plumbing law).
- Manufactured to AWWA C800 Specifications.
- Pack-joint end connections are designed to be installed onto the following tubing types:
  1. Types K or L copper water tubing compliant with ASTM B88.
  2. Polyethylene plastic tubing compliant with ASTM D2737 SDR 9 (insert stiffener required).
- Manufactured in an ISO accredited facility.

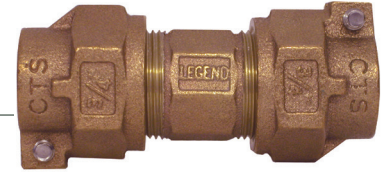

**Pictured:  
T-4301NL**



MATERIAL SPECIFICATION		
PART	MATERIAL	SPECIFICATION
1 Body	Lead-free cast bronze	ASTM B584 UNS C89836
2 Pack-joint nut	Cast bronze	ASTM B584 UNS C83600
3 Pack-joint gasket	Buna-N (NBR) nitrilic rubber	Commercial grade
4 Pack-joint anti-friction ring	Nylon* resin	Commercial grade
5 Pack-joint clamp bolt	Stainless steel	AISI grade 304

\*Nylon is a registered trademark of the DuPont company

DIMENSIONS			
Size	A	B	C
1/2"	0.48	3.51	1.56
3/4"	0.44	4.13	1.86
1" x 3/4"	0.49 / 0.44	4.20	2.20 / 1.86
1"	0.49	4.19	2.20
1-1/4" x 1"	0.57 / 0.49	4.53	2.86 / 2.20
1-1/4"	0.57	4.87	2.86
1-1/2" x 1"	0.61 / 0.49	5.37	2.84 / 2.20
1-1/2"	0.61	6.57	2.84
2"	0.71	7.21	3.63

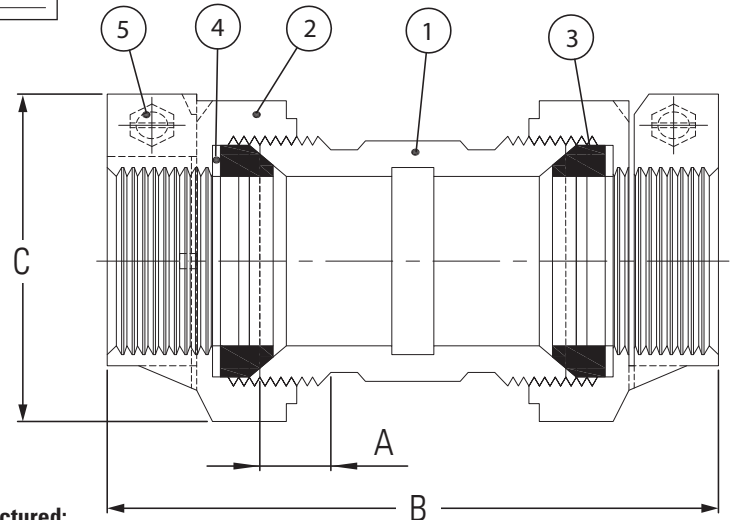

**Pictured:  
T-4301NL**  
Cutaway view