



# Diamond Tub & Showers Spec Sheet

**Model: TOCAW 6025**

**Description: Corner Tub with Apron, & Wainscot**

## Specifications

Model #	Material	Wall Finish	Pieces	Drain	Apron Height	Net Weight Lbs.
TOCAW 6025	Fiberglass/ Gelcoat	Smooth	1	Front Center	20 7/8"	

## Sump Data

Top of Drain to Bottom of Overflow	Capacity to Overflow Gallons	Top Dimensions		Bottom Dimensions	
		Length	Width	Length	Width
15"	87.5	NA	NA	NA	NA

## Framing Dimensions

A	B	C	D
60 1/8"	30"	14 3/4"	56 7/8"

Nailing Flange
1 1/8"

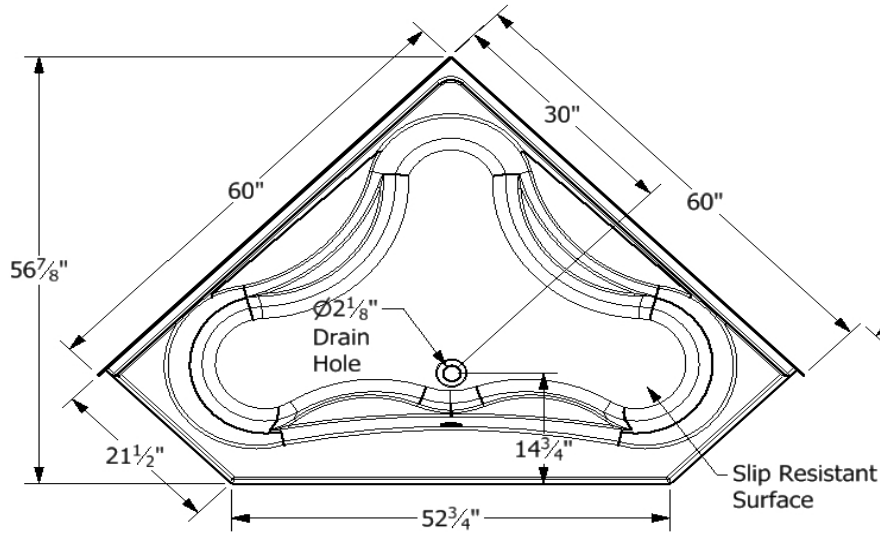

## Framing Specifications

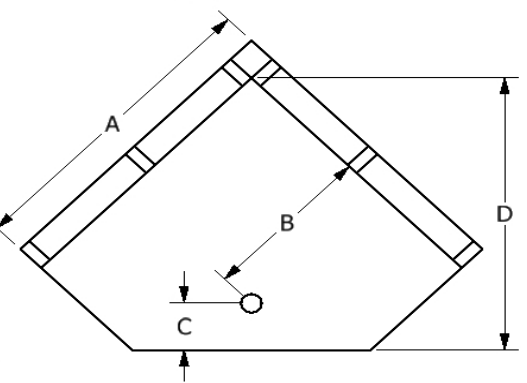

## 1 1/8" Flange

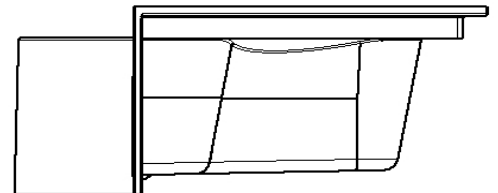
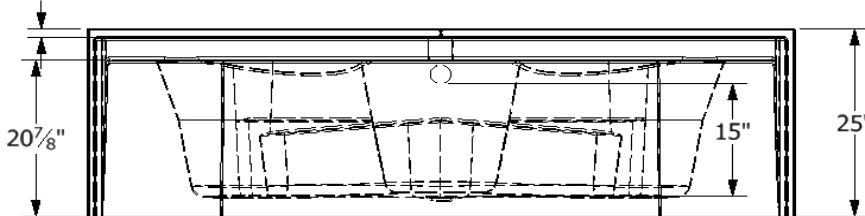

This product is tested by ICC-ES and is certified to conform to the requirements of CSA B45.5/IAMPO Z124 standard.

Manufactured by Frontline Mfg., Inc. Warsaw, IN



6/5/19